

Art. 91771

STRAP

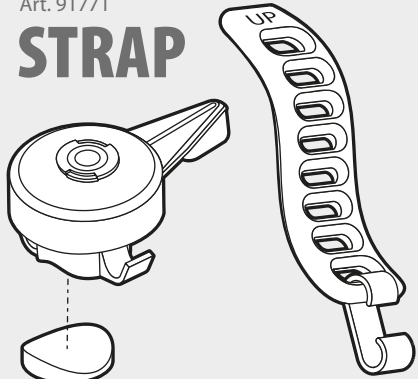

Spessore per manubri piatti
Spacer for flat handlebars

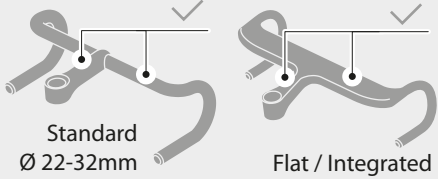

Quick side release

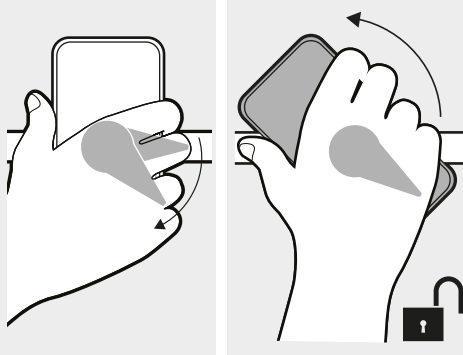
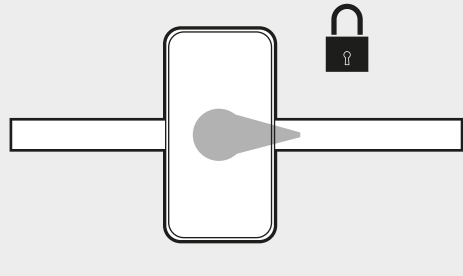

Portrait

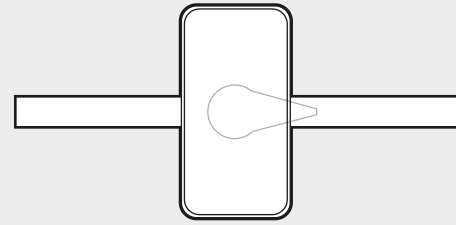

Landscape

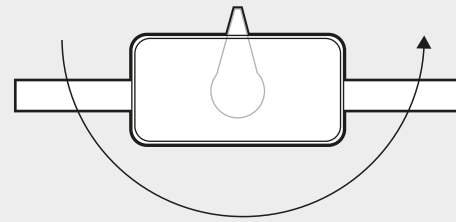

Option A

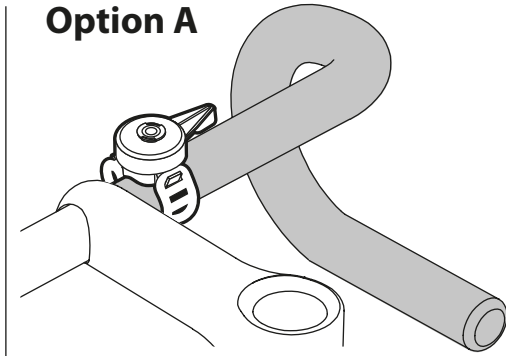

Option B

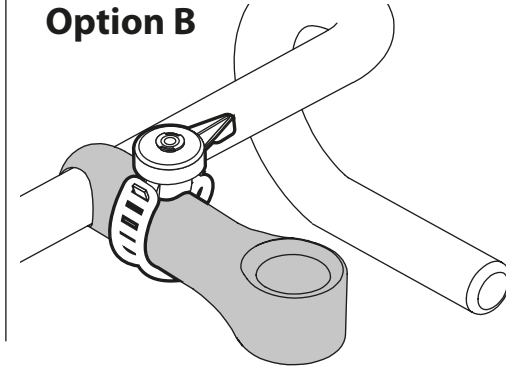

Video di installazione
Installation video



2

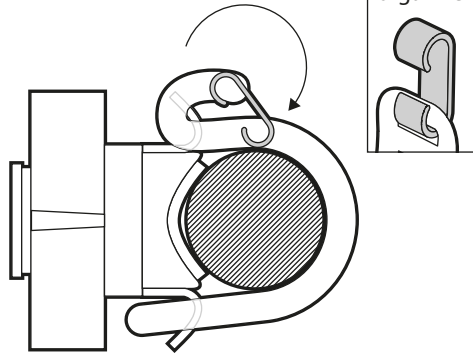

3

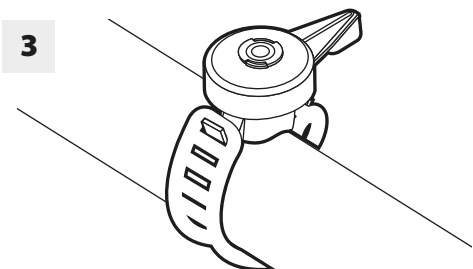

4

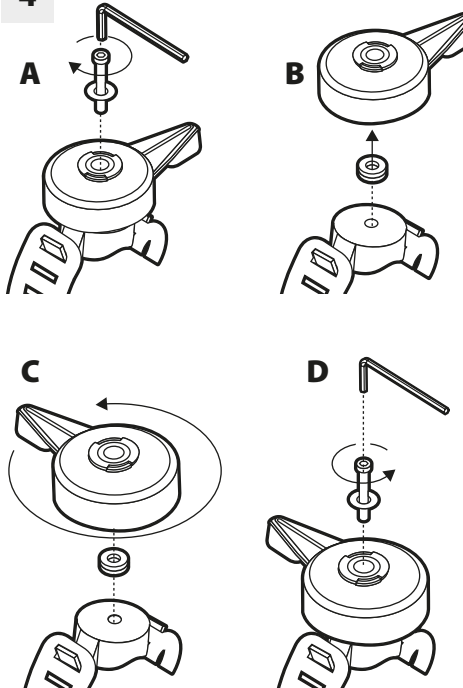

IT Il supporto può essere difficile da installare / rimuovere al di fuori della portata consigliata. Un serraggio eccessivo delle viti potrebbe danneggiare il prodotto, si prega di regolare con cautela.

EN The mount can be difficult to install / remove outside the recommended range. Over tightening the screws might damage the product, please adjust with caution.

FR Le support peut être difficile à installer/retirer en dehors de la plage recommandée. Un serrage excessif des vis peut endommager le produit, veuillez ajuster soigneusement.

ES El soporte puede ser difícil de instalar/quitar fuera del rango recomendado. Apretar excesivamente los tornillos puede dañar el producto; ajústelos con cuidado.

DE Außerhalb des empfohlenen Bereichs kann es schwierig sein, die Halterung anzubringen/zu entfernen. Zu starkes Anziehen der Schrauben kann das Produkt beschädigen, bitte sorgfältig einstellen.

NL De houder kan moeilijk te installeren/verwijderen zijn buiten het aanbevolen bereik. Schroeven kunnen losraken als gevolg van oncontroleerbare omstandigheden, controleer en draai ze gewoon vast voordat u ze installeert.